

Late Andrew Kinnear Now Wm Withman Esq.
FORM No. 1.

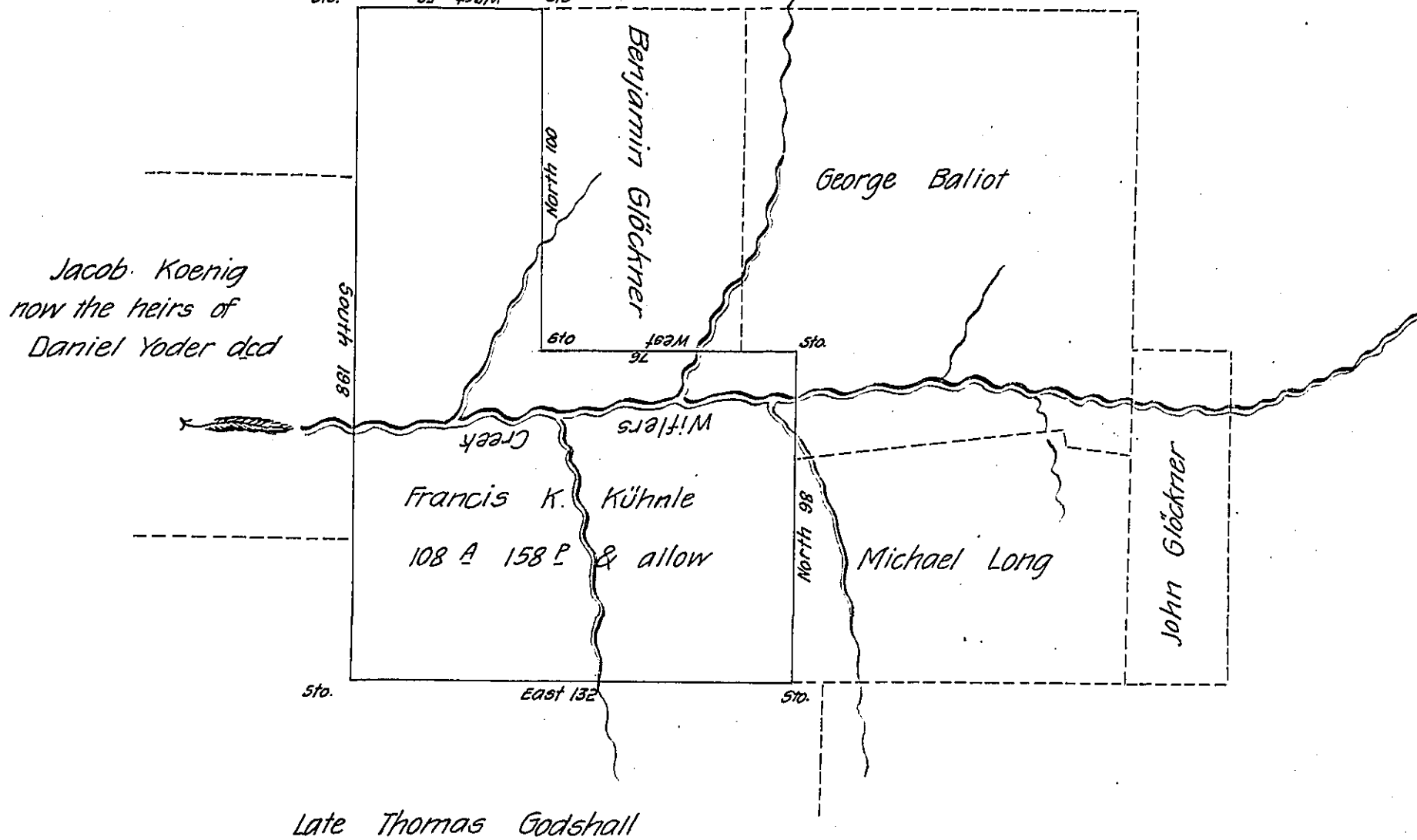

Situate in Brunsw^eig Township Schuylkill County Containing 108 A 158 P
 & Allowance of six per cents for Roads & Part of the same larger tract of 288 A
 25 P & Allowance which was surveyed to Sebastian Zimmerman by virtue of an Ap-
 pli^c N^o 1692 dated the 9th of July A.D. 1766 and which by an order from the Hon-
 ourable the Board of Property dated the 9th of October 1800 was devided and
 allotted equally to Thomas Godshall & George Weiser surveyed for Francis K.
 Kühnle June 7th 1822

By

Jn. Dreher D.S.

To Samuel Cochran Esq.
 Surveyor Gen^l of Pensy^a

IN TESTIMONY that the above is a copy of the original remaining on file in
 the Department of Internal Affairs of Pennsylvania, made
 conformably to an Act of Assembly approved the 16th day of
 February, 1833, I have hereunto set my Hand and caused
 the Seal of said Department to be affixed at Harrisburg,
 this third day of December 1906

Samuel Cochran
 Secretary of Internal Affairs.